

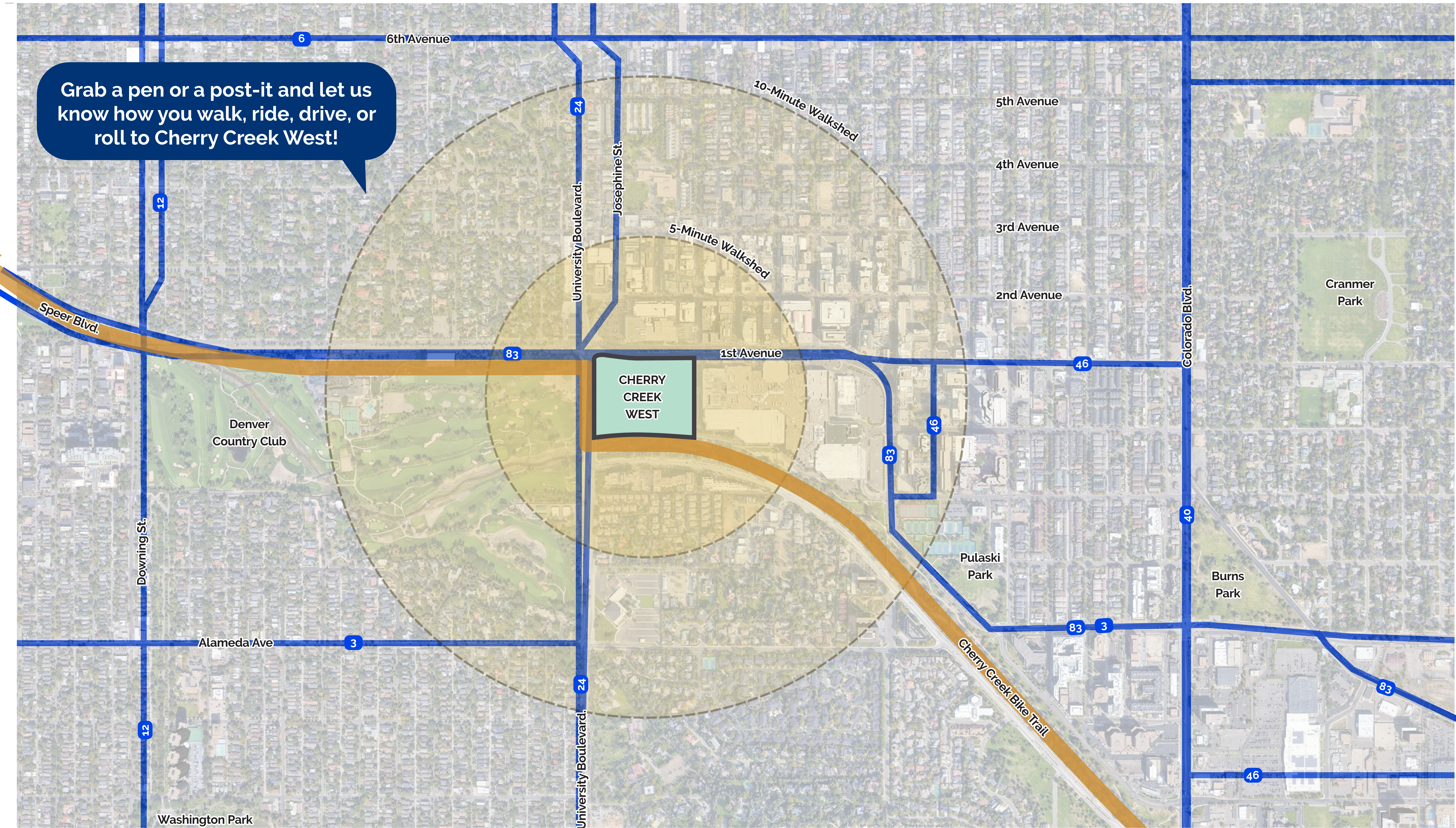

Grab a pen or a post-it and let us know how you walk, ride, drive, or roll to Cherry Creek West!

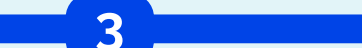





How will YOU get to Cherry Creek West?

-  Local Bus Routes
-  Regional Bike Trails



Legend

-  Vehicular Circulation
-  Proposed Pedestrian Circulation (Walk Bikes)
-  Shared Street (Pedestrian Priority with Vehicular Access)
-  Proposed Bike Circulation/ Dedicated Bike Lane
-  Existing Bike Circulation

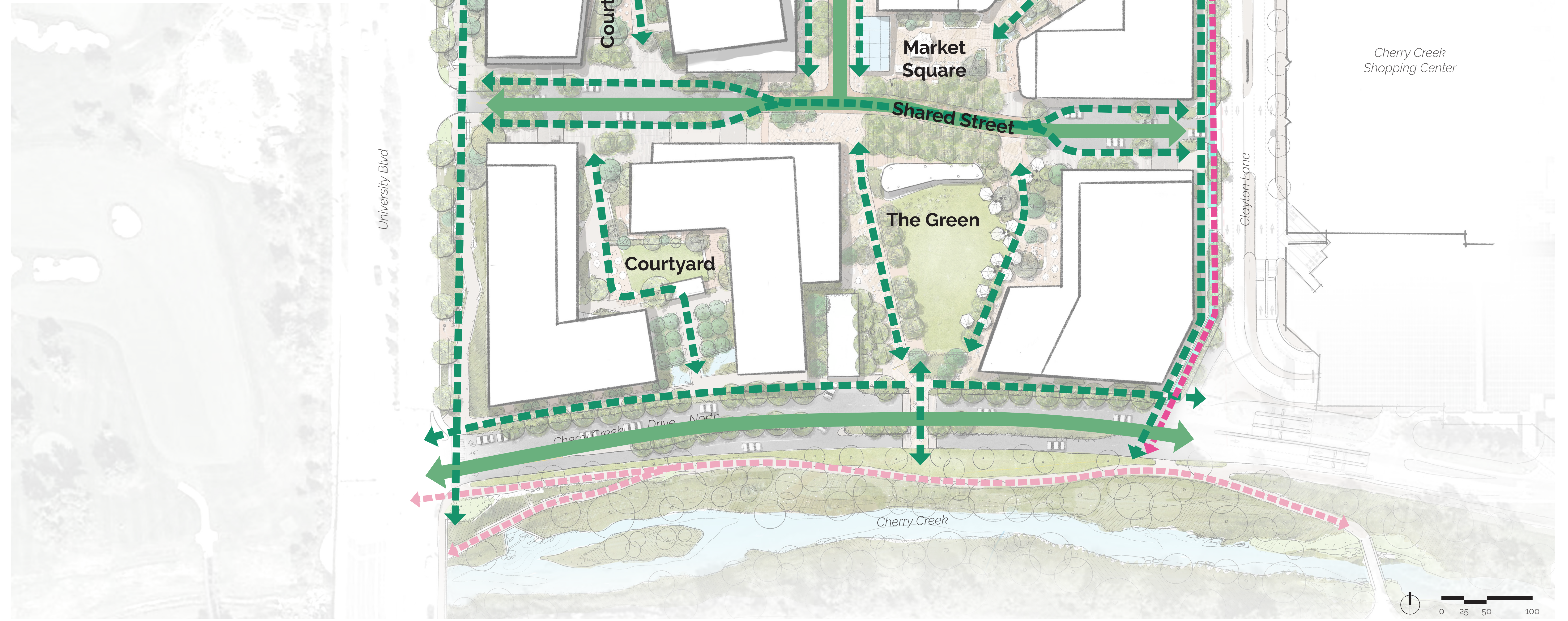

Proposed Site Circulation

Also known as a “pedestrian-priority” street, a **Shared Street** is a roadway designed for slow travel speeds where cycling, pedestrians, social activities, parking, and local car traffic combine to create a shared public space.

Our site will utilize removable bollards to create different shared street scenarios

Here’s how our shared street could function.... Which is your favorite?

Scenario 1a: Pedestrian Focused

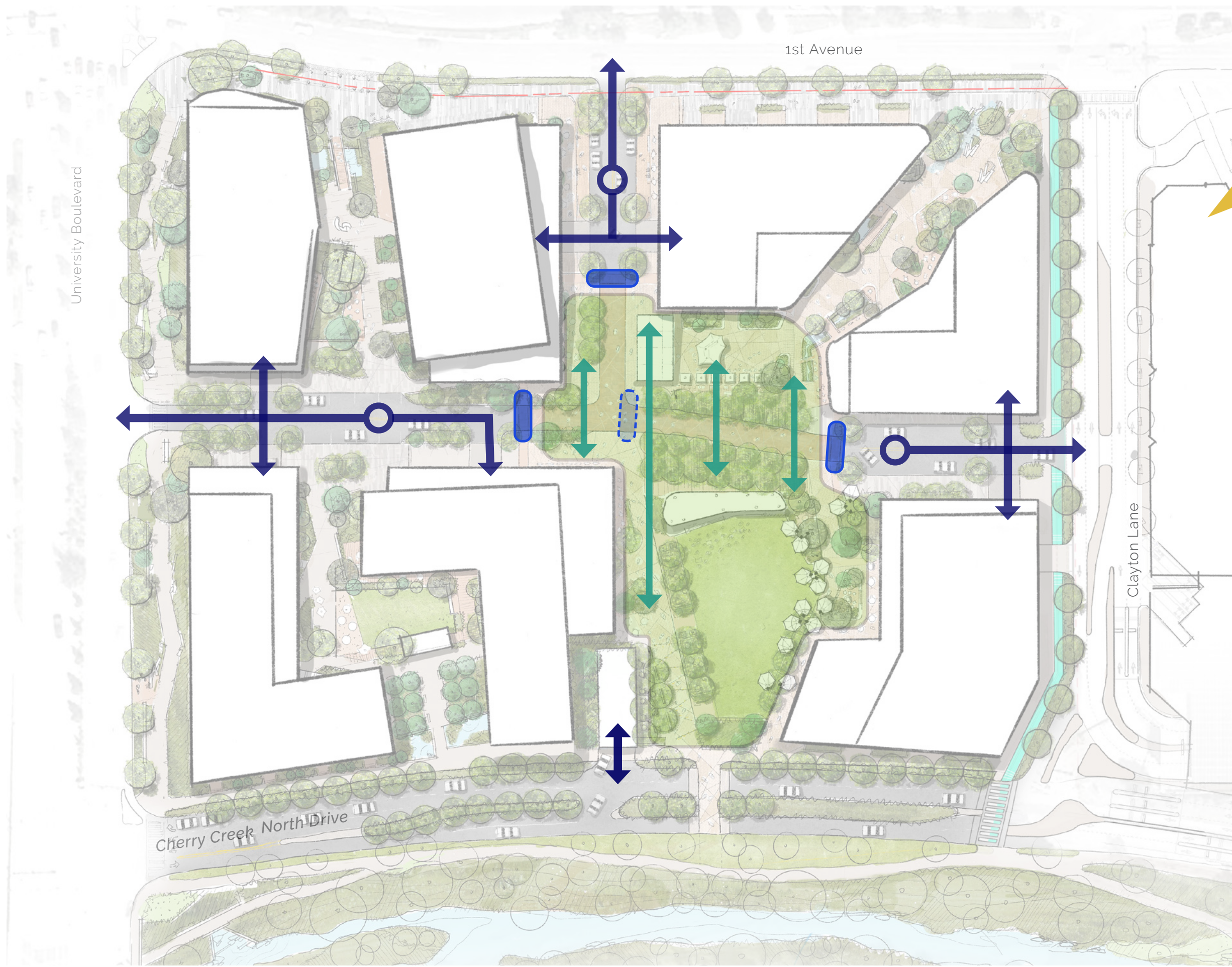

In this scenario there is full closure of the shared street, which would allow the entire heart of the site to be pedestrian only. Loading / drop off zones would accommodate traffic “turn arounds” in this scenario to provide a clear way for vehicles to enter/exit.



Scenario 1b: Pedestrian Focused with Limited Car Access

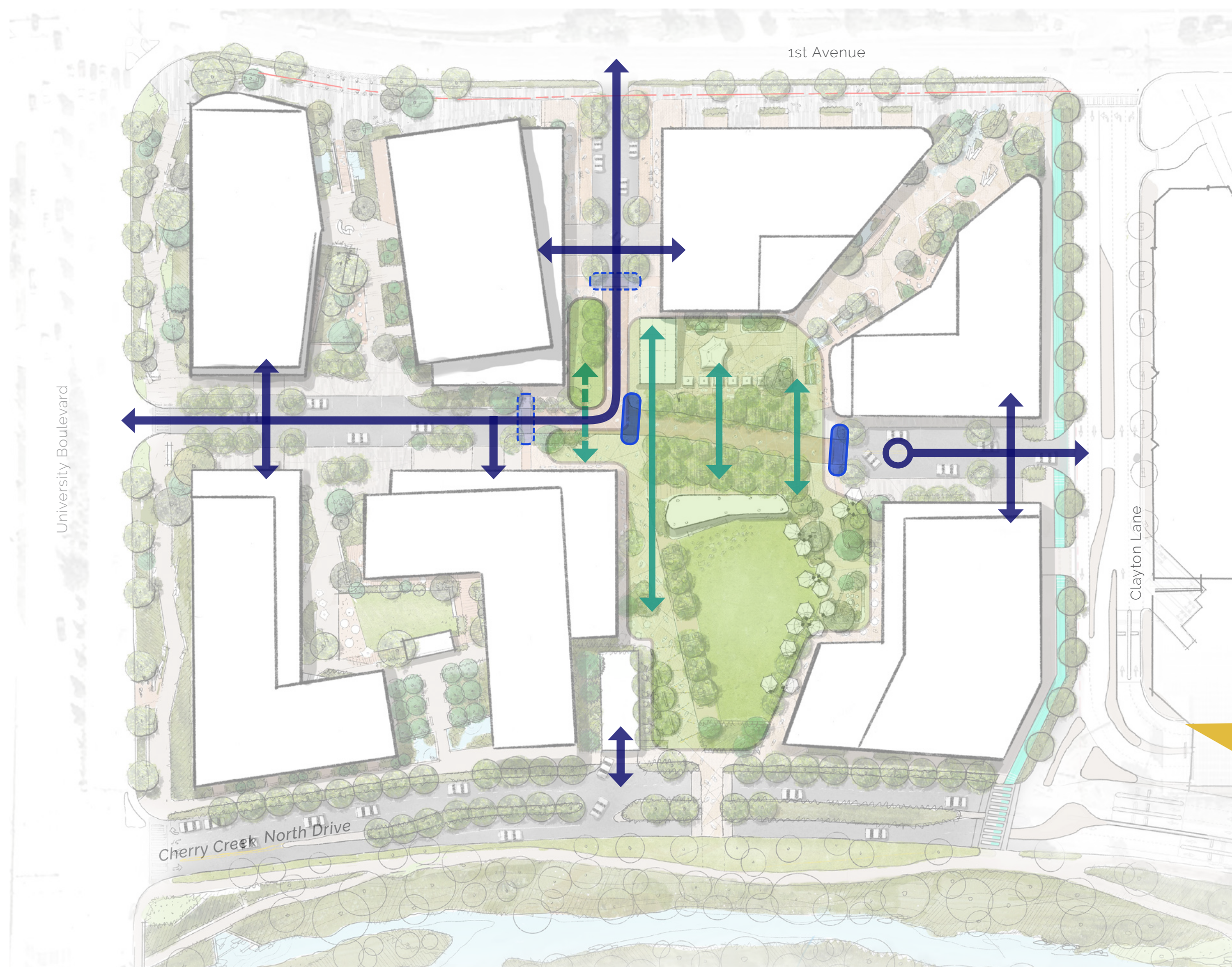

In this scenario, traffic is still redirected away from the heart of the site to allow for unrestricted pedestrian movement between Market Square and The Green, but also accommodates traffic to enter and exit from both University Boulevard, and 1st Avenue.

Scenario 2: Open to Cars

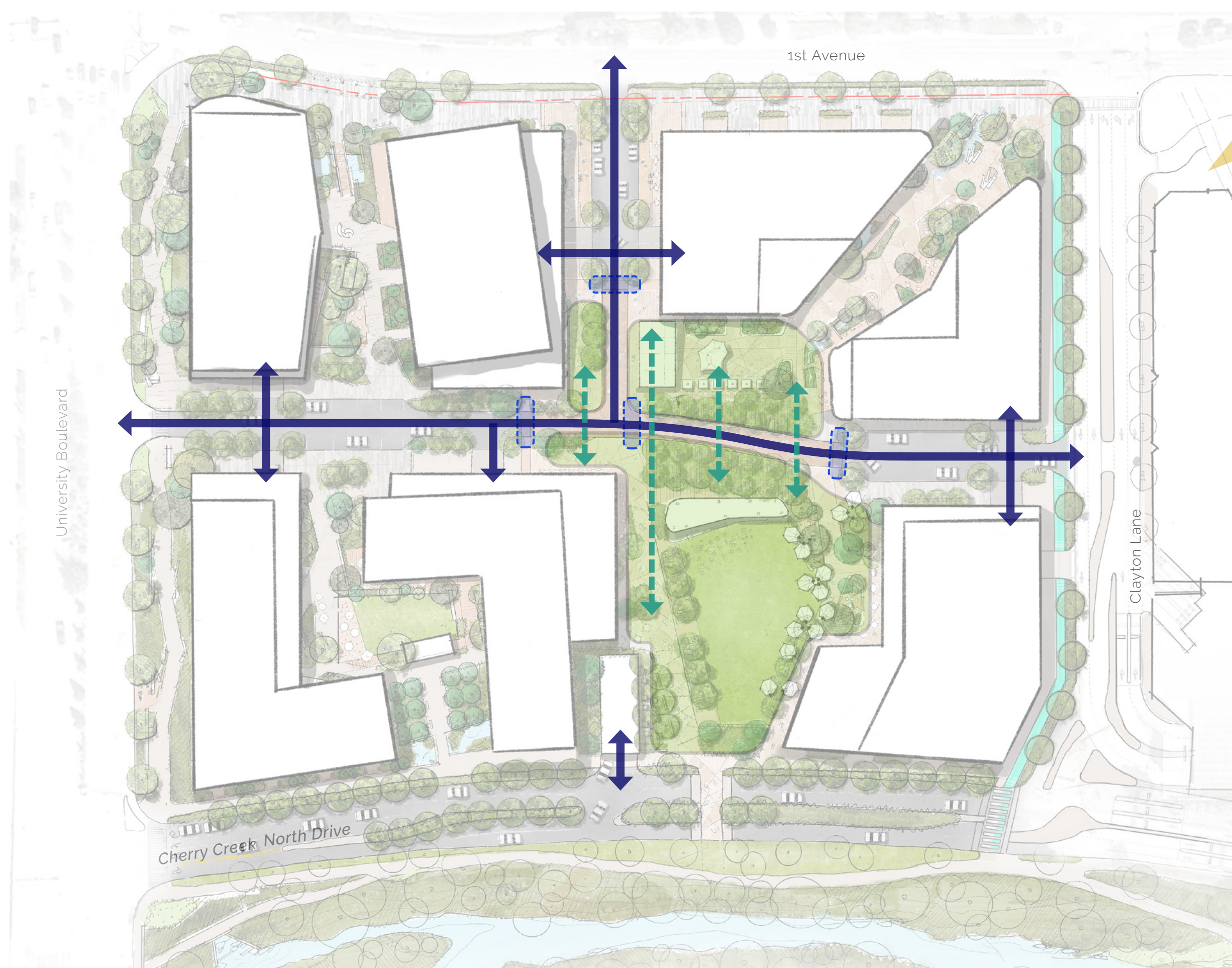

In a third scenario, the shared street can be open and allow through-traffic between University Boulevard, 1st Avenue, and Clayton Lane



Shared Street

Legend

- Pedestrian Circulation: No Conflict with Traffic
- Pedestrian Circulation: Crossing Traffic
- Removable Bollards: Up Position (Blocking Traffic)
- Removable Bollards: Down Position (Allowing Traffic)
- Vehicular Circulation
- Vehicular U-Turn

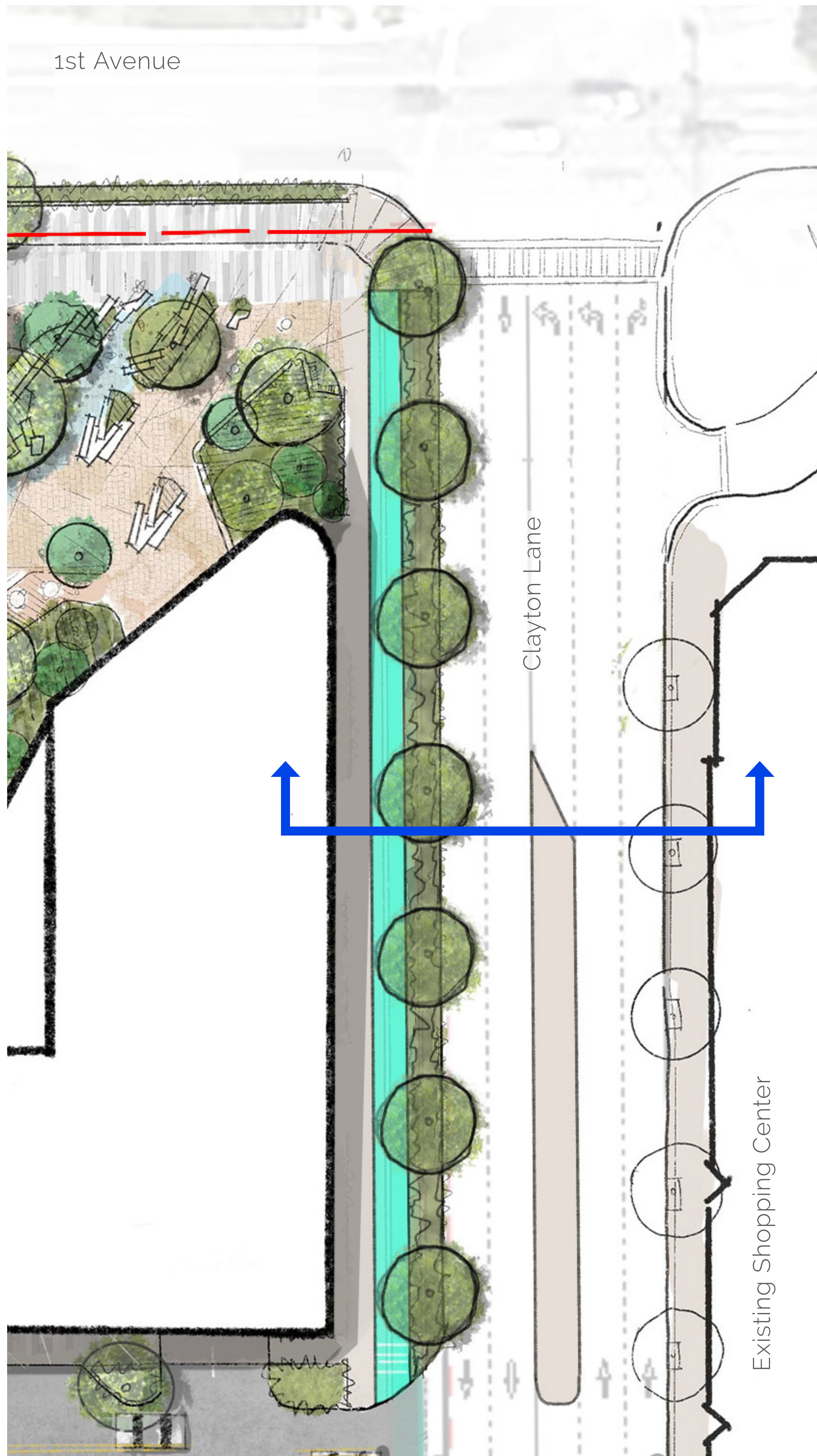

Example Imagery

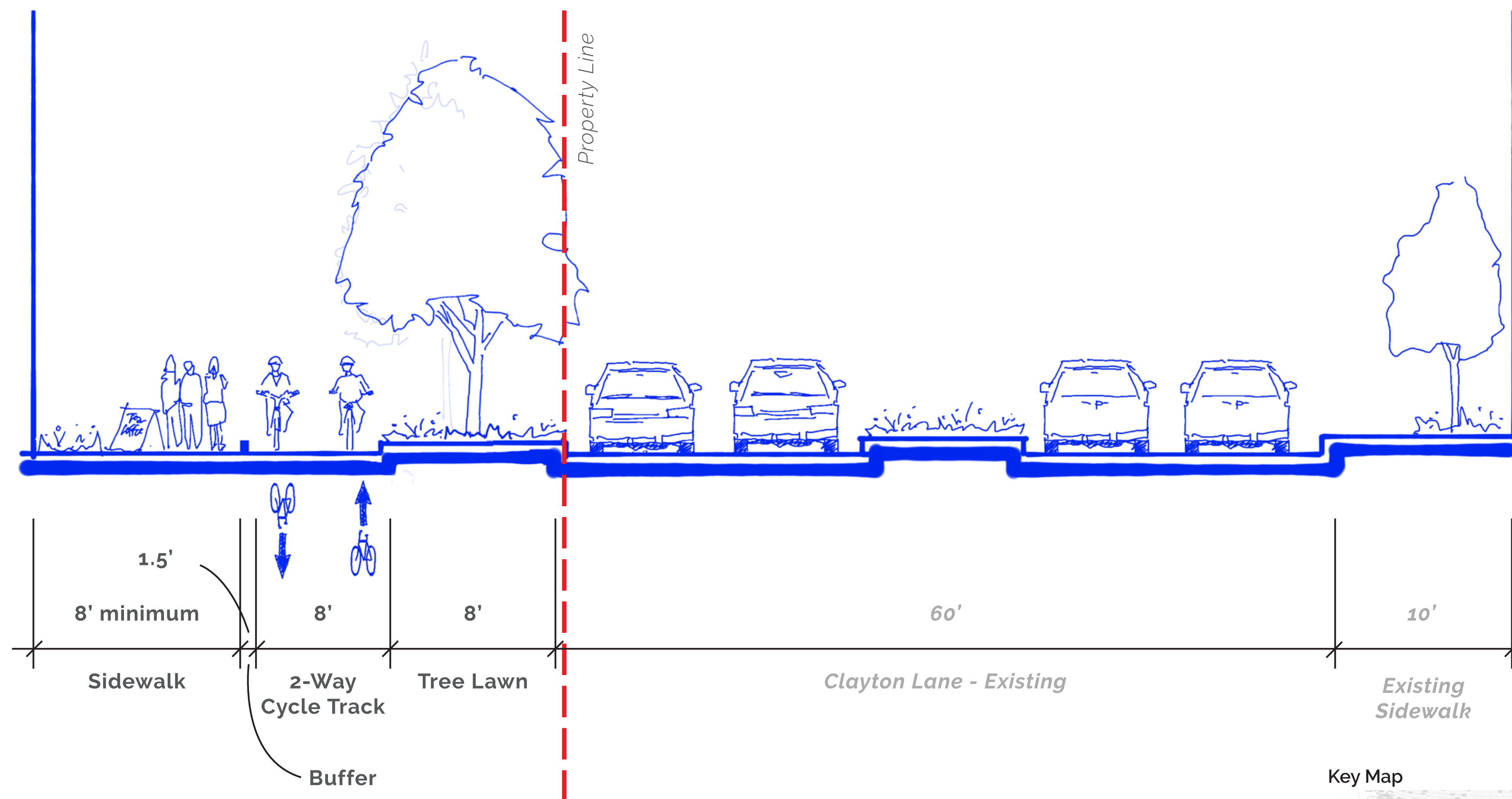

Key Map



Clayton Lane Proposed Section